



EXHIBITION PROPOSAL APPLICATION FORM

Curator/Artist(s)

Name:

Phone:

Address:

E-mail:

Exhibition/Project

Title:

Name[s] of artist[s]:

Space requirements: Gallery 1 only (West) Gallery 2 only (East) Both Galleries

Proposed/preferred exhibition dates:

Summary description of the project [max 5 lines]:

Appendices

- Detailed project description [max 2 A4 pages]
- Bio/CV of curator[s] and artist[s]
- Documentation/samples of artists work [max. 8 digital images] supplied as pdf or ppt

Send application to: East Gippsland Art Gallery info@eastgippslandartgallery.org.au

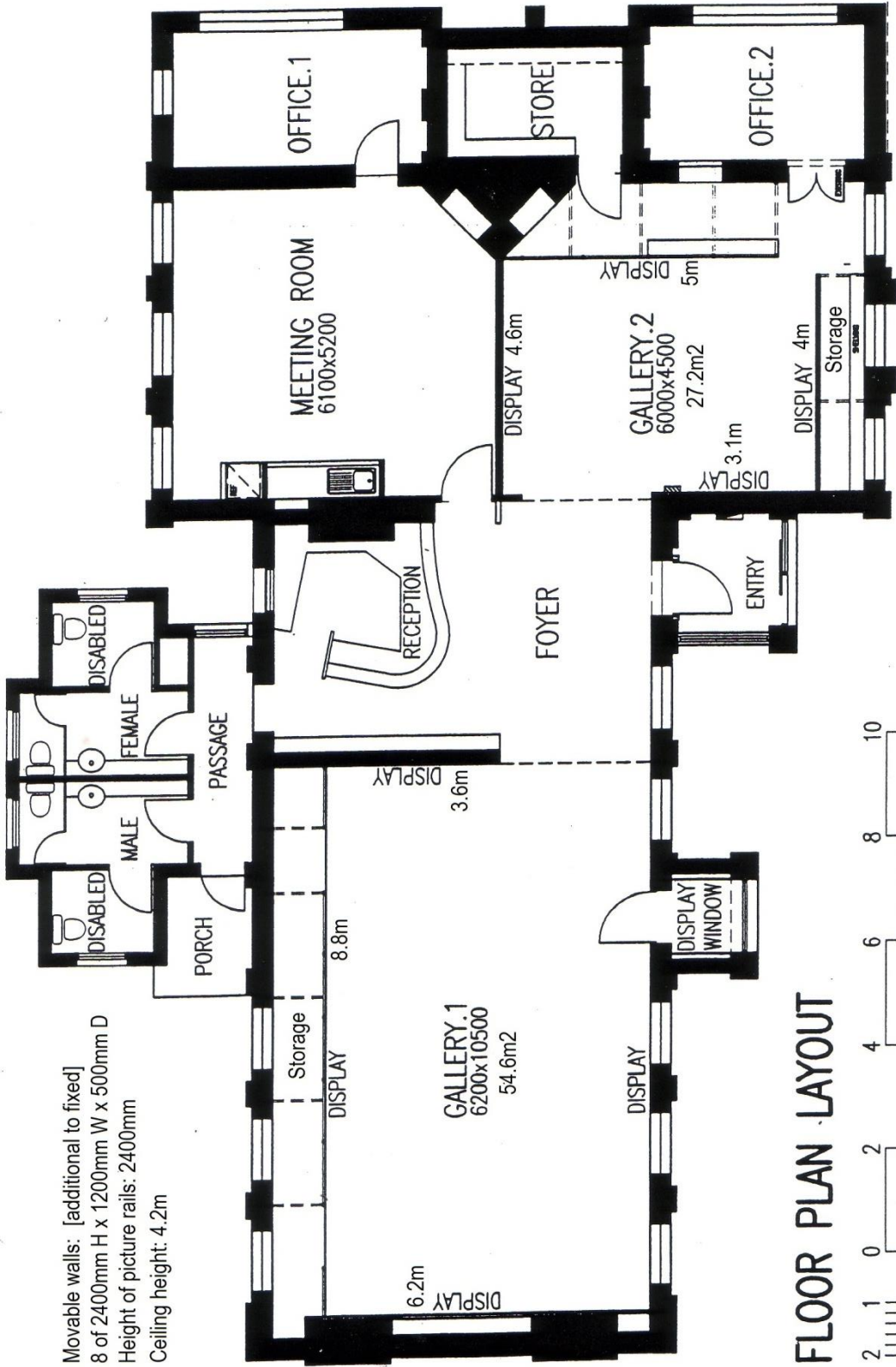

Movable walls: [additional to fixed]
 8 of 2400mm H x 1200mm W x 500mm D
 Height of picture rails: 2400mm
 Ceiling height: 4.2m

FLOOR PLAN LAYOUT



EAST GIPPSLAND ART GALLERY

2 NICHOLSON STREET, BAIRNSDALE 3875

East Gippsland Art Gallery is not equipped with climate control or variable lighting.

